

ADZ-SML

-1 1000
-60 125 %
IP65 (. IP69K)

и
и

:

ADZ-SML

(-1 1000)

-60 .



ADZ-SML

* p []	1,0	1,6	2,0	2,5	4,0	6,0	10,0	16,0
p []	6	6	6	6	10	20	20	40
p []	9	9	9	9	15	30	30	60
* p []	20	25	40	60	100	160	200	
p []	40	100	100	200	200	400	400	
p []	60	150	150	300	300	600	600	
* p []	250	400	600	1000				
p []	750	750	840	1200				-1...0,
p []	1000	1000	1050	1500	-1...9	24		

	2-	3-	3-	3-	3-
*	4...20	0...20	0...10	0...5	0,5...4,5
U [Vdc]	10...32**	9...30	12...32	8...32	5
R _n	R = (Us-10)/0,02A	. 200 **	4.7kΩ	≥4.7kΩ	≥4.7kΩ
t []	2	1	1	1	1
I []	23	40	10	10	7,5
			**		
* U [Vdc]	50	500/710			

(+23 °) %	0,50***	≤ 0,25	***		
BFSL	≤ 0,15				
/ %	0,15				

T [°C]	-40...125		
T [°C]	-60...125		
T [°C]	-60...125		
**** T [°C]	-20...85		****
%	0,15 / 10K		
%	0,15 / 10K		
%	- 60°C 2,00%		
%	-125°C 2,00%		

17-4 PH

m []	80-120	
g		DIN EN 60068-2-32
g	20	DIN EN 60068-2-6
g		DIN EN 60068-2-27

MVS/C



2



MVS/



S763

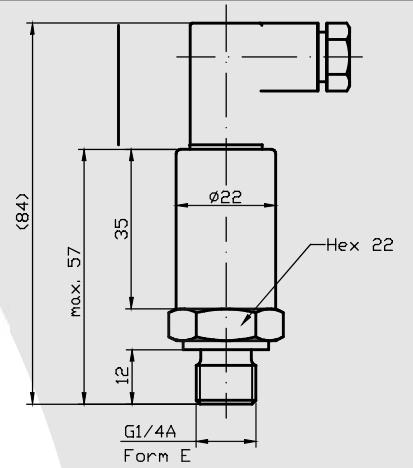

*

M12x1 (S763)
(IP67)

(IP67/IP69K)

(IP67/IP69K)

MVS/A
DIN EN 175301-803
(IP65)

MVS/C
DIN EN 175301-803
(IP65)

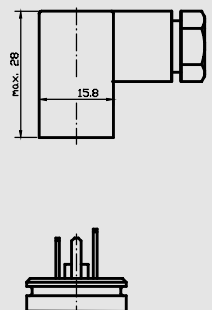
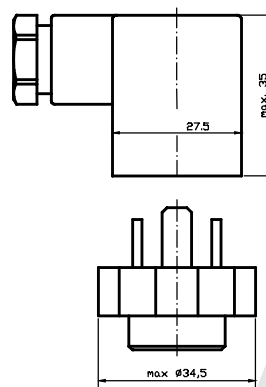
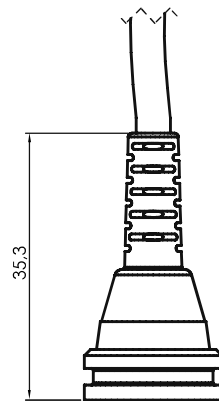
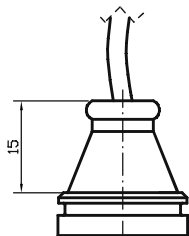
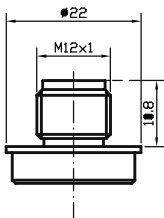

*

G 1/4" A;

G 1/4" B

G 1/2" B

1/4 " NPT

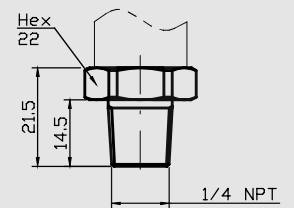
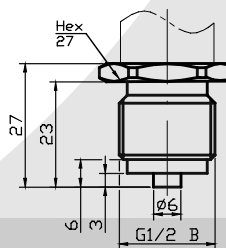
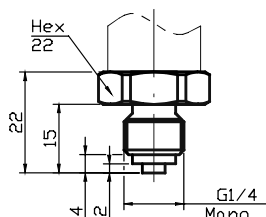
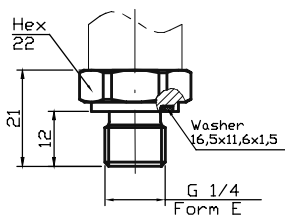

*

ADZ-SML

16.0 - 4...20 (2 .)	-1/0	0/16	BAR:	g -
10.0 - 4...20 (2 .)	-1/1	0/20	MPA:	a -
10.1 - 0...20	-1/5	0/40	KPA:	sr -
10.2 - 4...20 (3 .)	0/1	0/60	KGC: / 2	
10.8 - 0...5	0/1,6	0/100	PSI: psi	
20.0 - 0...10	0/2	0/160	MWS: . .	
20.1 - 1...5	0/2,5	0/200		
20.4 - 0...5	0/4	0/250		
20.11 - 0,5...5	0/6	0/400		
20.20 - 0...6	0/10	0/600		
20.23 - 0...2,5				
30.0 - 0,5...4,5 (.)				
31.0 - 0,5...4,5 (.)				
37.4 - 0,5...2,5 (.)				
37.7 - 0,5...2,0 (.)				
37.0 - 0,5...4,5 (.)				
40.0 - 0,5...4,5 (.)				

10: 1,0%	20: 20 1,5	G18A: G 1/8 A	MVC: MVS/C	R06 - 0,6
05: 0,5%	12 : 12 1 L=24	G14A: G 1/4 A	MVA: MVS/A	02C -
025: 0,25%	M12E: 12 1	G14B: G1/4 B	M12: S763 M12	4 -
	M12S: M12x1,5	G12B: G1/2 B	M16: S723 M16	-
	M14A: M14x1,5	G12E: G1/2 E	MIL: MIL C26482	
	M14E: M14x1,5	18NP: 1/8 NPT	KP1: 1	
	M16F: M16x1,5	14NP: 1/4 NPT	2RMD: 2	
	M18: M18x1,5	U98M: 9/16-18 UNF 2A	2RMT: 2	
	M18F: M18x1,5	M8A: M8x1		
	M18C: 18 1,5	M12: M12x1,25		
	M16A: M16x1,5			

: ADZ-SML-37.0 0/10 BAR G 05 M20 M12

ADZ NAGANO GmbH

“ 2001”

+7 (495)-921-30-12, +7 (495)-646-20-92

info@all-impex.ru

www.all-impex.ru